

# Mini & Compact Diaphragm Seals

DIAPHRAGM SEALS



W205 shown

- ▶ All-Welded Design  
No Gaskets or Bolts
- ▶ 1/4 NPT or 1/2 NPT  
Process Connections
- ▶ 316L Stainless Steel  
Construction

Terice **Mini & Compact Diaphragm Seals** provide an economical way to isolate and protect pressure instruments from corrosion and clogging.

**Style 205** Diaphragm Seals are designed for use with pressure ranges of 100 psi or greater and can be mounted to pressure gauges of 3 1/2" dial size or smaller.

**Style 305** Diaphragm Seals are designed for use with pressure ranges of 60 psi or greater and can be mounted to pressure gauges of 4 1/2" dial size or smaller.

**Style 306** Diaphragm Seals include all features found on the 305 with the addition of a 1/4 NPT flushing connection.

**Selection of the proper diaphragm seal is the sole responsibility of the user. Temperature and pressure limitations must be considered. Please refer to the Diaphragm Seal Design & Operation Section of this catalog. Improper application may cause failure of the seal, resulting in possible personal injury or property damage.**

**For correct use and application of all diaphragm seals, please refer to Diaphragm Seal Standard ASME B40.2.**

## SPECIFICATIONS

| Style | Diaphragm Type | Diaphragm Size | Minimum Pressure Range                    | Process Connection | Clean-out Design | 1/4 NPT Flushing Connection |
|-------|----------------|----------------|---|--------------------|------------------|-----------------------------|
| 205   | Welded Metal   | Mini           | 0 to 100 psi when mounted to 3 1/2" gauge | Threaded           | No               | No                          |
| 305   | Welded Metal   | Compact        | 0 to 60 psi when mounted to 4 1/2" gauge  | Threaded           | No               | No                          |
| 306   | Welded Metal   | Compact        | 0 to 60 psi when mounted to 4 1/2" gauge  | Threaded           | No               | Yes                         |

## HOW TO ORDER

Sample Order Number: **W 2 05 01 S S S**

| Diaphragm Type | Diaphragm Size | Style                         | Connection Size            | Diaphragm Material | Process Housing Material | Instrument Housing Material |
|----------------|----------------|-------------------------------|----------------------------|--------------------|--------------------------|-----------------------------|
| W Welded       | 2 Mini         | 05 Non Clean-out, Welded Body | See Connection Sizes Table | S 316 SS           | S 316 SS                 | S 316 SS                    |
|                | 3 Compact      | 06 Flushing, Welded Body      |                            |                    |                          |                             |

# Mini & Compact Diaphragm Seals

All dimensions are nominal. Dimensions in [ ] are in millimeters.

DIAPHRAGM SEALS

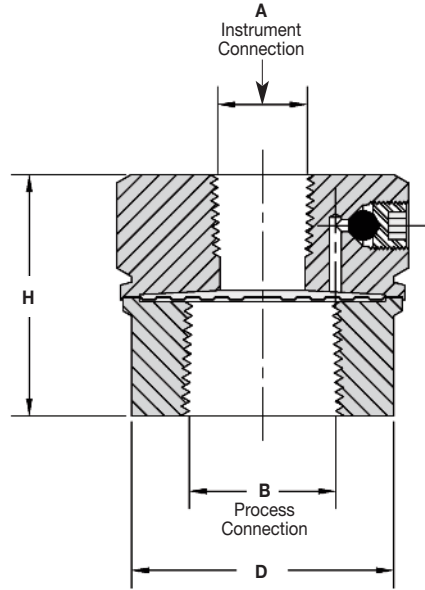

| Style | A                         | B                         | H         | D         |
|-------|---------------------------|---------------------------|-----------|-----------|
| 205   | 1/4 NPT                   | 1/4, 1/2 NPT as specified | 1.24 [31] | 1.35 [34] |
| 305   | 1/4, 1/2 NPT as specified | 1/4, 1/2 NPT as specified | 1.75 [44] | 2.25 [57] |
| 306   | 1/4, 1/2 NPT as specified | 1/4, 1/2 NPT as specified | 1.50 [38] | 1.89 [48] |

## Sizes

| Connection Sizes |                             |                          |
|------------------|-----------------------------|--------------------------|
| Code             | Instrument Connection (NPT) | Process Connection (NPT) |
| 01               | 1/4                         | 1/4                      |
| 02*              | 1/2                         | 1/4                      |
| 03               | 1/4                         | 1/2                      |
| 04*              | 1/2                         | 1/2                      |

\* Not available on style 205.