

# Solid State Relay

## TA600 Series • AC Output



TA625 shown

The Trerice **TA600 Series** Solid State Relay has no moving parts, rendering it impervious to shock and vibration, and giving it a virtually infinite life.

### HOW TO ORDER

Please order using Item Number **TA610**, **TA625** or **TA640**

All dimensions are nominal. Dimensions in [ ] are in millimeters.

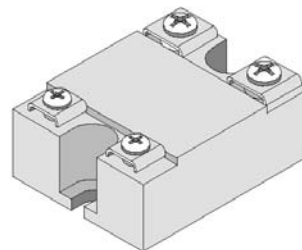
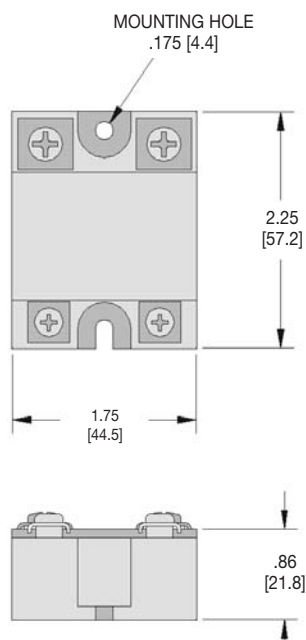

### Specifications

#### Models

<b>TA610:</b>	10 A output
<b>TA625:</b>	25 A output
<b>TA640:</b>	40 A output

<b>Case</b>	Epoxy molded with aluminum baseplate
-------------	--------------------------------------

<b>Connection</b>	Screw terminals
-------------------	-----------------

<b>Input</b>	Voltage: 3-32 VDC Impedance: 1000Ω minimum Must turn on: 3.0 VDC Must turn off: 1.0 VDC Isolation signal to load: 7000 VDC Isolation signal to base: 2500 VDC Capacitance signal to load: 15 pt
--------------	---

<b>Output</b>	Voltage: 20~300 Vrms Typical turn-on voltage: 5 Vrms Response time: 0.5 cycle max. OFF state DV/DT: 200 V/m sec OFF state leakage current: 15 mA Max. non-repetitive single cycle surge current: 400 A Cycle surge current: 400 A IT for fusing (T=8.3 ms): 400 AS Peak inverse voltage: 600 Vpk
---------------	--

#### Ambient Temperature

-20°F (-30°C) to 140°F (60°C)

#### Approximate Shipping Weight

0.2 lbs [0.09 kg]