

Air Vents

DESCRIPTION

The Cash Acme Air Vents are for use in heating systems to vent air trapped within the circulating water.

The Cash Acme Air Vents are available in in 1/8", 1/4", 1/2", 3/4" and 1" high capacity sizes.

FEATURES AND BENEFITS

High quality brass body with a nickel plated finish:
Durable construction for long lasting service.

Economical and easy to install:
Saves money and time!

Wide range of sizes:
Fits a variety of heating systems.

TYPICAL INSTALLATION

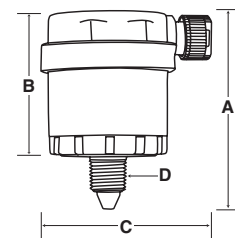
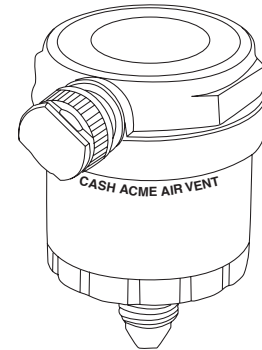
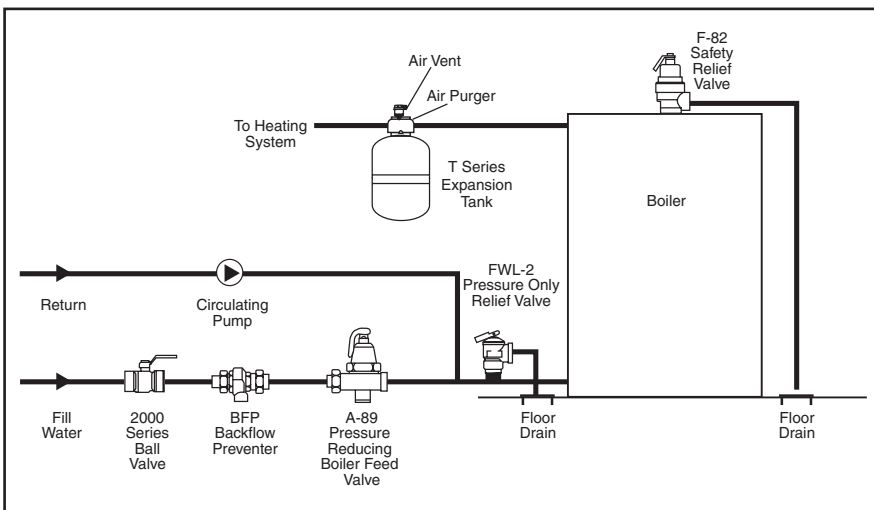

150 psi

Item	A	B	C	D
24090	1.94"	1.55"	1.86"	1/8" NPT
24091	1.94"	1.55"	1.86"	1/4" NPT

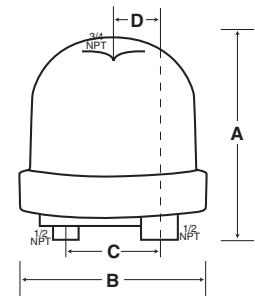

125 psi

Item	A	B	C	D
24095	5.32"	4.75"	2.156"	1.062"

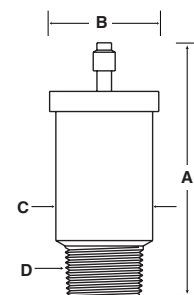

90 psi

Item	A	B	C	D
24092	2.64"	1.86"	1.65"	1/2" NPT
24093	2.64"	1.86"	1.65"	3/4" NPT
24094	2.64"	1.86"	1.65"	1" NPT

SPECIFICATION DATA

Performance:

Working pressure90 -150 psi (or refer to chart)

ServiceWater

Materials:

Body:Brass, nickel plated

CONNECTIONS

Threaded (NPT)1/8", 1/4", 1/2", 3/4" and 1"