

FW and FWC Miniature Relief Valves

DESCRIPTION

The Cash Acme FW miniature relief valves are designed for commercial and industrial applications including thermal expansion protection, static pressure and over-pressure relief, very low capacity pump relief, and other uses of similar nature where tight shut-off is required.

The Cash Acme FW and FWC Valves are small, low-cost relief valves suitable for static over-pressure protection. A calibrated adjusting screw allows for occasional changes in pressure setting without the use of a pressure gauge (FWC only). Brass bodies come with male inlet and female outlet, silicone seat and stainless steel spring. The FW and FWC valves have standard factory pressure settings of 125 psi.

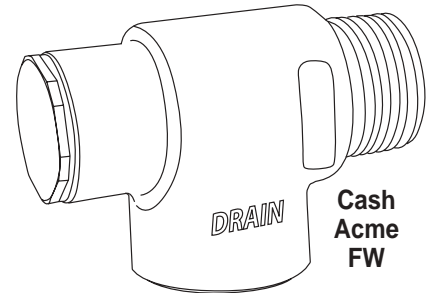

FEATURES AND BENEFITS

Offers protection against problematic and over-pressure conditions:

Thermal expansion protection, static pressure and over-pressure relief, very low capacity pump relief and other uses of similar nature where tight shut-off is required.

Commercial and industrial applications:

Designed to meet the needs of a wide variety of water systems.

Every valve is tested for performance prior to shipping:

Specify and install with confidence!

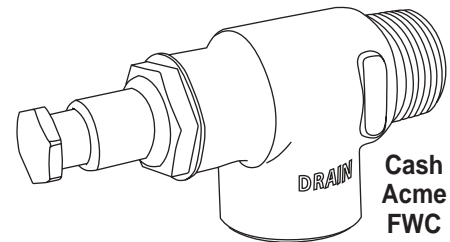

SPECIFICATION

FW: A miniature relief valve shall be installed to relieve pressure for applications where tight shut-off is required. The valve shall be of bronze construction with a male inlet and female outlet. The valve shall have a silicone seat and a stainless steel pressure spring. The valve shall be a **Cash Acme FW Relief Valve**.

FWC: A miniature relief valve shall be installed to relieve pressure for applications where tight shut-off is required. The valve shall be of bronze construction with a male inlet and female outlet. The valve shall have a silicone seat and a stainless steel pressure spring. The valve shall have a calibrated adjusting screw. The valve shall be a **Cash Acme FWC Relief Valve**.

FW and FWC Miniature Relief Valves

TYPICAL INSTALLATION

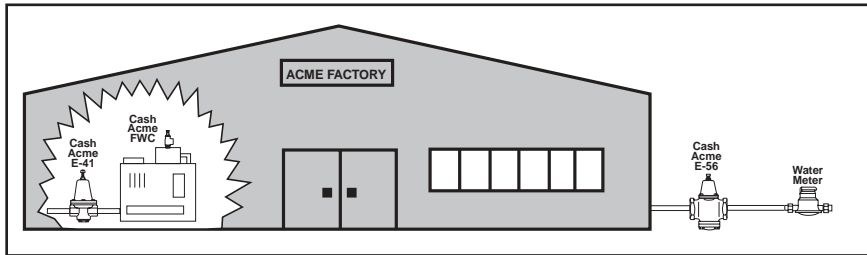

SPECIFICATION DATA

Performance:

Set pressure range15 - 200 psi (Type F) and 25 - 175 psi (Type FWC)
 Maximum temperature210° F
 ServiceWater

Materials:

BodyBrass
 Pressure SpringStainless steel
 Seat DiscSilicone

CONNECTIONS

Threaded (NPT)male inlet and female outlet

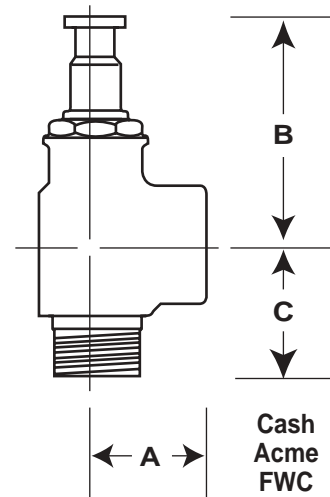
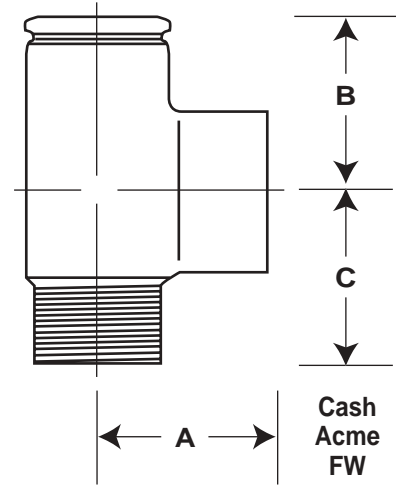

Dimensions	A	B	C
FW - 1/2"	1 3/16"	1 11/32"	1 1/2"
FW - 3/4"	1 3/16"	1 11/32"	1 1/2"
FWC - 1/2"	1 3/16"	2 5/8"	1 1/2"
FWC - 3/4"	1 1/4"	2 5/8"	1 1/2"