

# F-82 ASME Safety Relief Valve

## DESCRIPTION

The Cash Acme F-82 is a pressure-only ASME relief valve designed for use on hot water space heating boilers, water supply heaters and storage tanks.

The Cash Acme F-82 Safety Relief Valves are designed for use on hot water service only and are not to be used on steam.

The **Cash Acme F-82** is available in  $\frac{3}{4}$ ", 1", 1 $\frac{1}{4}$ ", 1 $\frac{1}{2}$ " and 2" sizes. It has a female inlet and outlet. The **Cash Acme F-82 ASME Safety Relief Valve** has a standard factory pressure relief setting of either 30 psi or 125 psi. Other settings from 30 psi to 150 psi are available when specified. These high capacity pressure-only relief valves feature brass bodies, silicone seat discs and stainless steel pressure springs.

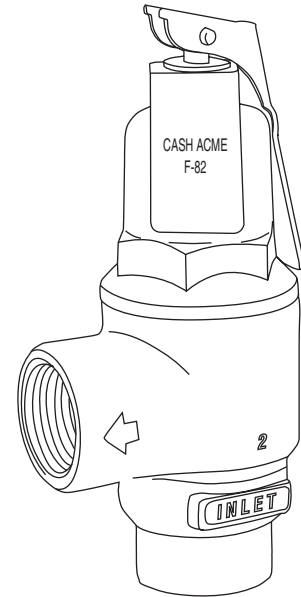

## FEATURES AND BENEFITS

Compact and economical:

*Saves space and money!*

Completely automatic and reseats after temperature or pressure relief:

*Ideal for most domestic water heater applications.*

ASME Section IV listed:

*Rated for emergency steam discharge by the National Board of Boiler and Pressure Vessel Inspector.*

Every valve is tested for performance prior to shipping:

*Specify and install with confidence!*

## SPECIFICATION

A high capacity relief valve shall be installed to relieve pressure at a pre-determined set. The valve shall have a brass body with female inlet and outlet. The valve shall have a silicone seat disc and stainless steel pressure spring. The valve shall be ASME listed and National Board Certified. The valve shall be a **Cash Acme F-82**.

# F-82 ASME Safety Relief Valve

## TYPICAL INSTALLATION

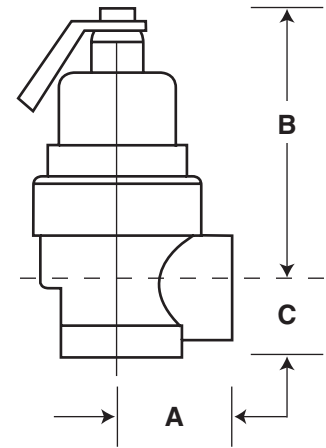
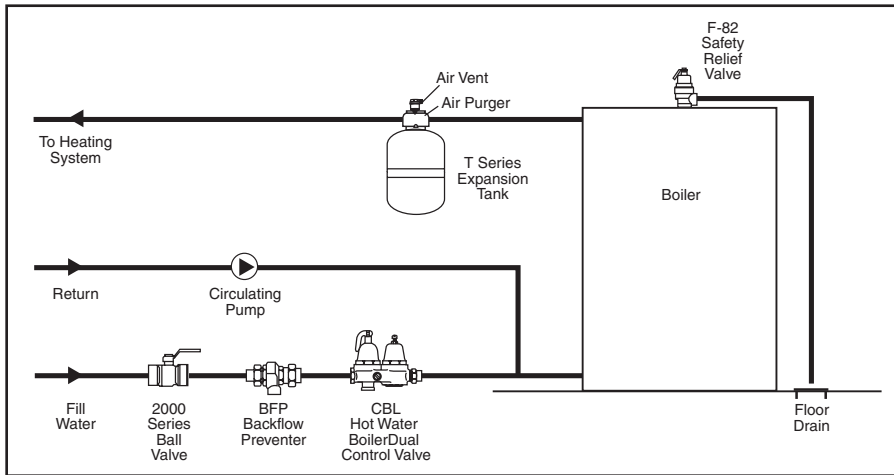

Dimensions	A	B	C
3/4" x 3/4"	1 1/2"	3 1/2"	1 11/16"
1" x 1"	1 3/4"	4 11/32"	1 7/64"
1 1/4" x 1 1/4"	2 1/16"	5 9/16"	1 1/2"
1 1/2" x 1 1/2"	2 15/32"	5 7/8"	1 21/32"
2" x 2"	3"	7 1/2"	2 5/32"

## SPECIFICATION DATA

### Performance:

Set pressure range . . . . .30-150 psi  
 Maximum temperature . . . . .210° F  
 Service . . . . .Water

### Materials:

Body . . . . .Brass  
 Seat Disc . . . . .Silicone  
 Pressure Spring . . . . .Stainless steel

## CONNECTIONS

Threaded (NPT) . . . . .Female inlet and female outlet

## CERTIFICATIONS

The Cash Acme F-82 Relief Valve is certified to ANSI Z21.22 and is listed by ASME.

ASME RELIEF CAPACITIES AT STANDARD SETTINGS - BTU/HR STEAM RELIEF					
Relief Setting	F-82 3/4" x 3/4"	F-82 1" x 1"	F-82 1-1/4" x 1-1/4"	F-82 1-1/2" x 1-1/2"	F-82 2" x 2"
30 psi	717,000	1,025,000	1,704,000	2,085,000	3,902,000
50 psi	1,048,000	1,498,000	2,490,000	3,047,000	5,701,000
75 psi	1,462,000	2,090,000	3,472,000	4,249,000	7,951,000
100 psi	1,875,000	2,680,000	4,454,000	5,451,000	10,200,000
125 psi	2,289,000	3,271,000	5,437,000	6,653,000	12,450,000
150 psi	2,703,000	3,862,000	6,419,000	7,855,000	14,700,000