

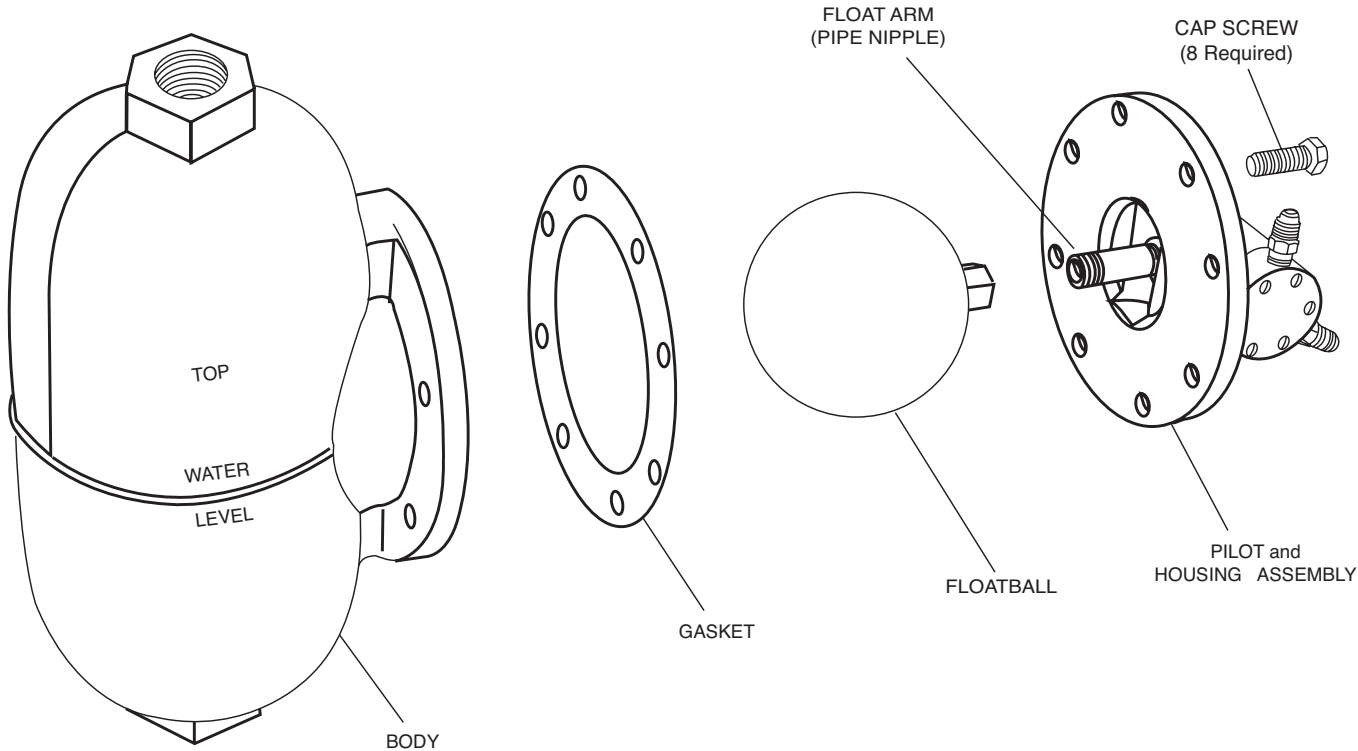

— MODEL — **CFC2**

# Float Chamber Control



Common Parts:

Description	Material
Float Ball	S.S.
*Gasket	Neoprene
Cap Screws	Steel Cad.
3/8-16 x 7/8	Plated

NOTE: SEE OTHER SIDE FOR EXPLORED PILOT AND HOUSING ASSEMBLY.

CATALOG NO.	BODY	PILOT & HOUSING ASS'Y	PIPE NIPPLE 1/4 X 2"
	MATERIAL	MATERIAL	MATERIAL
CFC2-A1	Iron	Bronze with S.S.	Bronze 67586-03
CFC2-A2	Iron	Bronze with S.S.	Bronze 67586-03
CFC2-C1	Iron	Bronze with S.S.	Bronze 67586-03
CFC2-A1	Iron	Steel with S.S.	S.S. 67586-19
CFC2-C1	Iron	Steel with S.S.	S.S. 67586-19
CFC2-A1	Steel	Steel with S.S.	S.S. 67586-19
CFC2-A2	Steel	Steel with S.S.	S.S. 67586-19
CFC2-C1	Steel	Steel with S.S.	S.S. 67586-19



— Model —

**CFC2**

## Pilot & Housing Assembly For Float Chamber Control

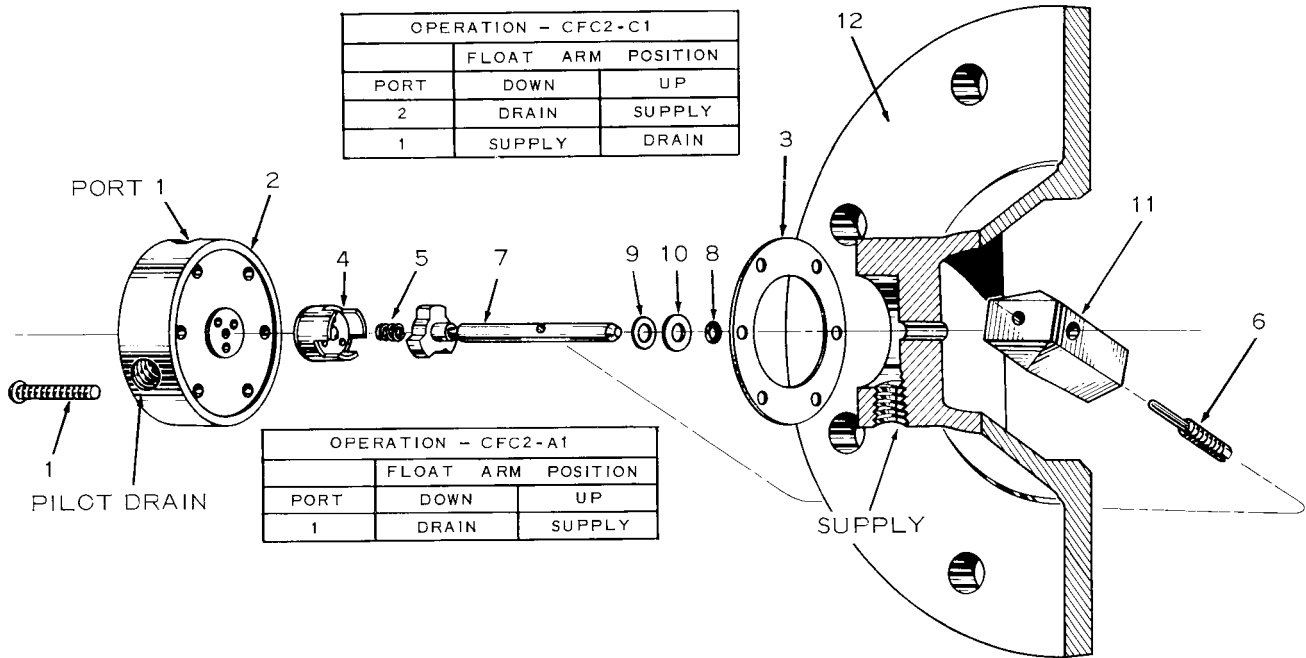

PILOT & HOUSING ASSEMBLIES (BRONZE W/STAINLESS STEEL)  
 C426-1 FOR CFC2-A1 OR CFC2-A2-3  
 C2035 FOR CFC2-A2 OR CFC2-B2-3  
 C2149H FOR CFC2-C1 OR CFC2-B2-4

ITEM	DESCRIPTION	MATERIAL
1	Machine Screw, Rd. Hd., 6/32 x 1", 6 Required	Brass
*2	Distributor for C426-1 Distributor for C-2035 Distributor for C-2149-1	S.S. S.S. S.S.
*3	Gasket	Buna-N®
*4	Disc Assembly	Brass Monel
*5	Spring	S.S.
6	Pin, Lock	S.S.
7	Stem Assembly	Brass - S.S.
*8	"O" Ring	Buna-N®
9	Washer	Brass
10	Washer, Thrust	Brass
11	Arm, Float	Brass
12	Housing	Bronze

PILOT & HOUSING ASSEMBLIES (BRONZE W/STAINLESS STEEL)  
 C426-1 FOR CFC2-A1 OR CFC2-A2-3  
 C2035 FOR CFC2-A2 OR CFC2-B2-3  
 C2149-1 FOR CFC2-C1 OR CFC2-B2-4

ITEM	DESCRIPTION	MATERIAL
1	Machine Screw, Rd. Hd., 6/32 x 1", 6 Required	Steel Cad. Plated
*2	Distributor for C-8017 Distributor for 32340 Distributor for 30792	S.S. S.S. S.S.
*3	Gasket	Buna-N®
*4	Disc Assembly	S.S.
*5	Spring	S.S.
6	Pin, Lock	S.S.
7	Stem Assembly	S.S.
*8	"O" Ring	Buna-N®
9	Washer	S.S.
10	Washer, Thrust	S.S.
11	Arm, Float	S.S.
12	Housing	Steel

Distributed By: M&M Control Service, INC.

Phone: 800-876-0036 Fax: 847-356-0747 Email: Sales@mmcontrol.com